

SUGGESTED PAD LAYOUT

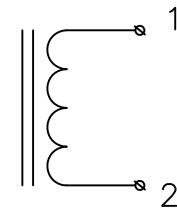
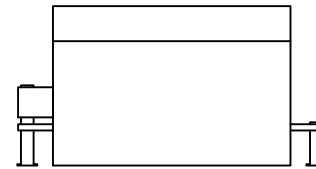
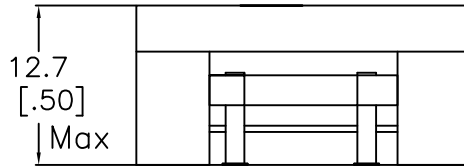
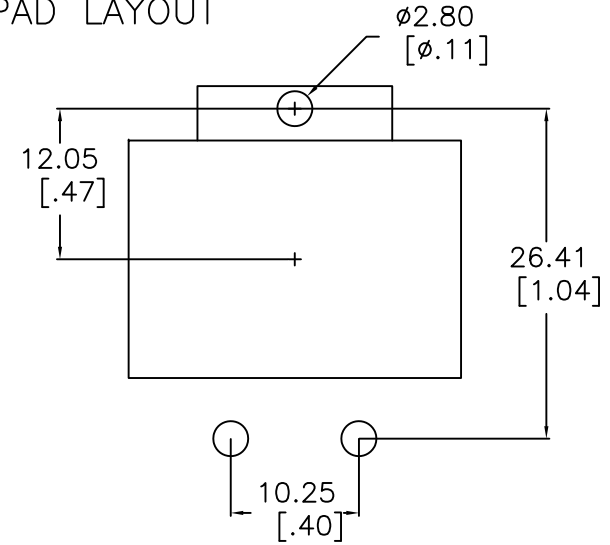

NOTES:

1. INDUCTANCE [1-2] = 220 uH Nom, 198 Min. @100kHz 1.0V 5.0 Adc
2. INDUCTANCE [1-2] = 187 uH Min @100kHz 1.0V 6.0 Adc @25C
3. DCR [1-2] = 58 mohms Nom, 63 Max
4. DIELECTRIC ISOLATION > 500 VDC [1-2], : CORE
5. SATURATION CURRENT @25C = 6.0 Adc | @100C = 5.0 Adc
6. HEATING CURRENT FOR 45C RISE AT 25C AMBIENT = 6.8 Adc
7. Operating Ambient Temperature: -55C to +130C [Inclusive of Temps Rise]
8. RoHS Level 6/6 Compliance || 96/4 Sn/Ag Pin Composition

No.	DESCRIPTION	REVISIONS	DATE	APPR
CHAMPS TECHNOLOGIES				
THIRD ANGLE PROJECTION 		Champs No. PQI26-220-LTC		
TOLERANCES +/- 1.0 UNLESS OTHERWISE INDICATED		SIGN	DATE	Customer
.XXX ± 0.180	DRAWN			Part #:
.XX ± 0.25	CHKD			ISSUE
.X ± 1.5	APPR		08.17.15	A
ANGLE ±			SIZE	REV
			SCALE 2:1	00