

# MECHANICAL DIMENSIONS [TOP VIEW]

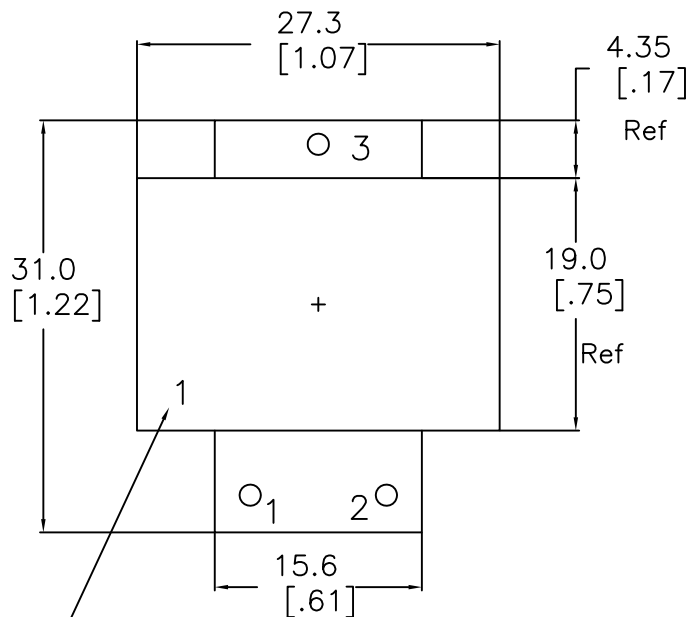

Mark #1 on Ferrite Core

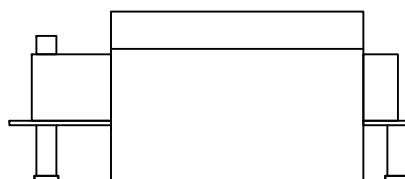
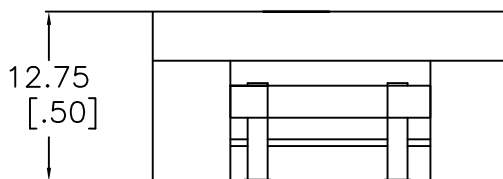

# SUGGESTED PAD LAYOUT [PCB TOP VIEW]

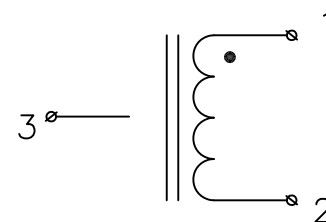
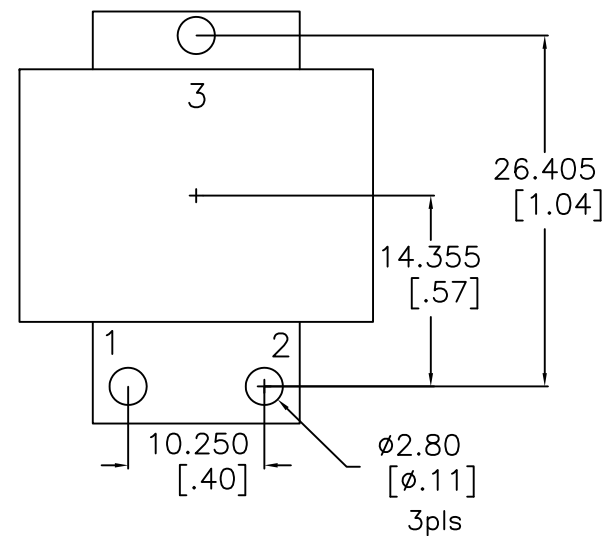

## NOTES:

1. INDUCTANCE [1-2] = 78 uH Nom, 70 Min. @100kHz 1.0V 9.3 Adc
2. INDUCTANCE [1-2] = 65 uH Min @100kHz 1.0V 10.8 Adc @25C
3. DCR [1-2] = 28 mohms Nom, 32 Max
4. DIELECTRIC ISOLATION > 500 VDC [1-2], : CORE
5. SATURATION CURRENT @25C = 10.8 Adc | @100C = 10.0 Adc
6. HEATING CURRENT FOR 45C RISE AT 25C AMBIENT = 9.5 Adc
7. TEMPERATURE RATING: -55C to +130C [Inclusive of Temp Rise]
8. RoHS Level 6/6 Compliance || 96/4 Sn/Ag Pin Composition

No.	DESCRIPTION	REVISIONS	DATE	APPR
THIRD ANGLE PROJECTION				
CHAMPS TECHNOLOGIES				
TOLERANCES/UNITS in MM UNLESS OTHERWISE INDICATED		SIGN	DATE	Champs-Tech PN PQI26-78R-LTC
.XXX ± 0.380	DRAWN			Customer
.XX ± 0.54	CHKD			Part #:
.X ± 1.0	APPR		06.16.17	SIZE SCALE
ANGLE ±				ISSUE A REV 00